



Yarnfield and Cold Meece Parish Council Village Green Project Proposals

March 2025

1 Scope of the work to be included in the section 106 funded project.¹

1.1 Consideration should be given to:

- Improving accessible play equipment: currently there is one piece of equipment that would meet this criterion.
- Improving the educational value of the playground, possibly with panels and games.
- Providing some facilities for older children.
- Reducing the number of litter bins by replacing with covered bins.

1.2 This approach is likely to be viewed sympathetically by the borough council and ward representatives, who will need to support the work being proposed.

2 Site Overview

2.1 The footprint of the playground is relatively small considering the amount of play equipment on it. This will affect the configuration of the site as new equipment is added.



¹ Parish Council meeting 12 February, 2025 Resolution #####

2.2 The site has evolved over many years with equipment being added on at least two occasions. The 2025 project should aim to bring a sense of consistency and remove the worst elements of the playground that have been inherited by the parish council.

3 Demographic profile of the parish

3.1 The population growth in the parish over the last 10 years has had a significant impact on the number of children and young people living in the parish. The village green project needs to reflect the impact this population growth is having on the existing facilities and enhance the facilities available for play.

3.2 The 2021 Census recorded a 173% increase in the number of 0 -19 years children living in the parish since the 2011 census.

3.3 The number of young families now living in the parish is likely to mean the number of children will continue at the same level for the foreseeable future.

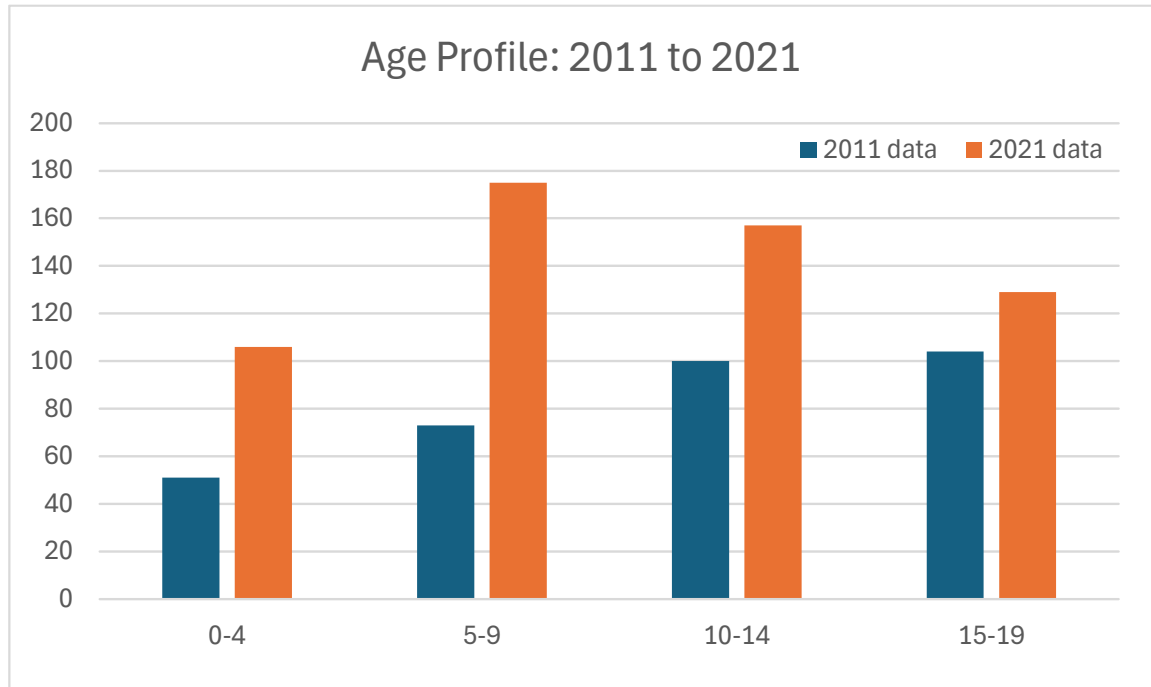

4 Maintenance Implications

4.1 One of the problems we face is the deterioration of the safety play surface under the equipment. Deterioration of the surface and the trip hazard at the junction of the surface and the surrounding areas is routinely highlighted in the annual safety inspection report.

The section106 money cannot be used to pay for maintenance. Any repair work or maintenance of the equipment or safety surface will be a recurring revenue cost to the parish council.

5 Working Group

5.1 The working group is made up of:

- Cllr Hughes
- Cllr Simpson
- Cllr Whitfield
- Parish Clerk

5.2 Details of the equipment and facilities being proposed are set out in Section 6.

5.3 The constrained nature of the playground will mean the proposals will require some changes to the existing equipment or their location:

- Stand on rocker
- Four-way springer – moved to new location
- Cradle swing – replace
- Surfboard – remove

5.4 The rationale for the changes is set out in detail in Section 7 – Review of Existing Play Equipment

5.5 Plans of the existing site and the proposed site layouts can be found on pages 8 and 9.

5.6 The details of the proposed new equipment have been taken from the Sutcliffe Play catalogue. There are other companies that will provide equipment of a similar design and specification.

5.7 The project will require quotations from at least three companies. The final details and equipment installed may be affected by which company is selected to deliver the project.

5.8 The purpose of this report is to secure agreement to a set of design principles and equipment requirements.

6 Suggestions for new equipment and fixtures

Group Seesaw

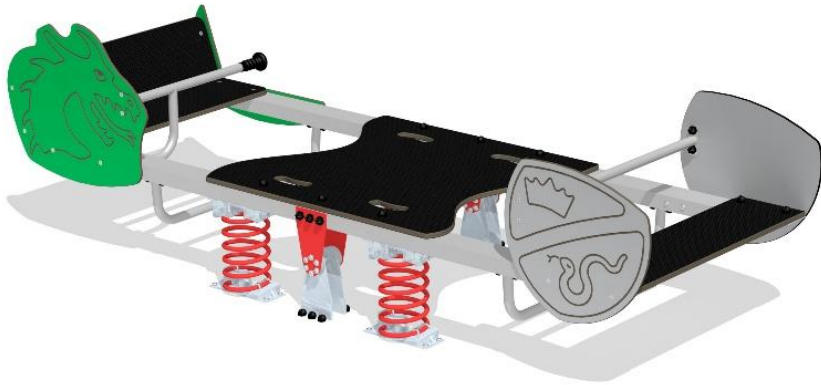

- A cutaway feature enables users to side transfer on to one side of the seesaw.
- The central platform enhances the social dimension as users can face each other at either end.

Inclusive Swing Seat

- Modular Swing Seat
- Modular swing seat allows for 1, 2,3 or 4 seat of differetn types to be used on a single frame.



Activity Trail – example of possible options

- wide range of options available



Natural Grass Mound

- There is enough space on the site to allow a small extension on the area of the playground to form a natural grass mound.
- The construction of a grass mound would provide a sense of enclosure for the playground, and provide a space for active play.
- The design of the mound can be as simple as a grass bank or more complex, depending on how much is spent on this element of the project.
- The grass mound would also provide a virtual perimeter to the playground and a sense of enclosure.
- Advice on the dimensions of the mound should be sought to ensure it can easily be included in the grass cutting arrangements for the village green.



Interactive surface marking



- There are obvious benefits from providing simple games, such as hopscotch, that are seen in school playgrounds where ample tarmac surfaces exist.
- There is a single straight length of tarmac in the playground which may be appropriate.
- Consideration will need to be given to any conflict this may have with the other play equipment and whether the tarmac strip is wide enough.

Litter bins and seats

- To continue to be emptied by Stafford Borough Council: replacement bins will need to meet their specification.
- Possibly supplied at no cost by Stafford Borough Council ?



Existing layout

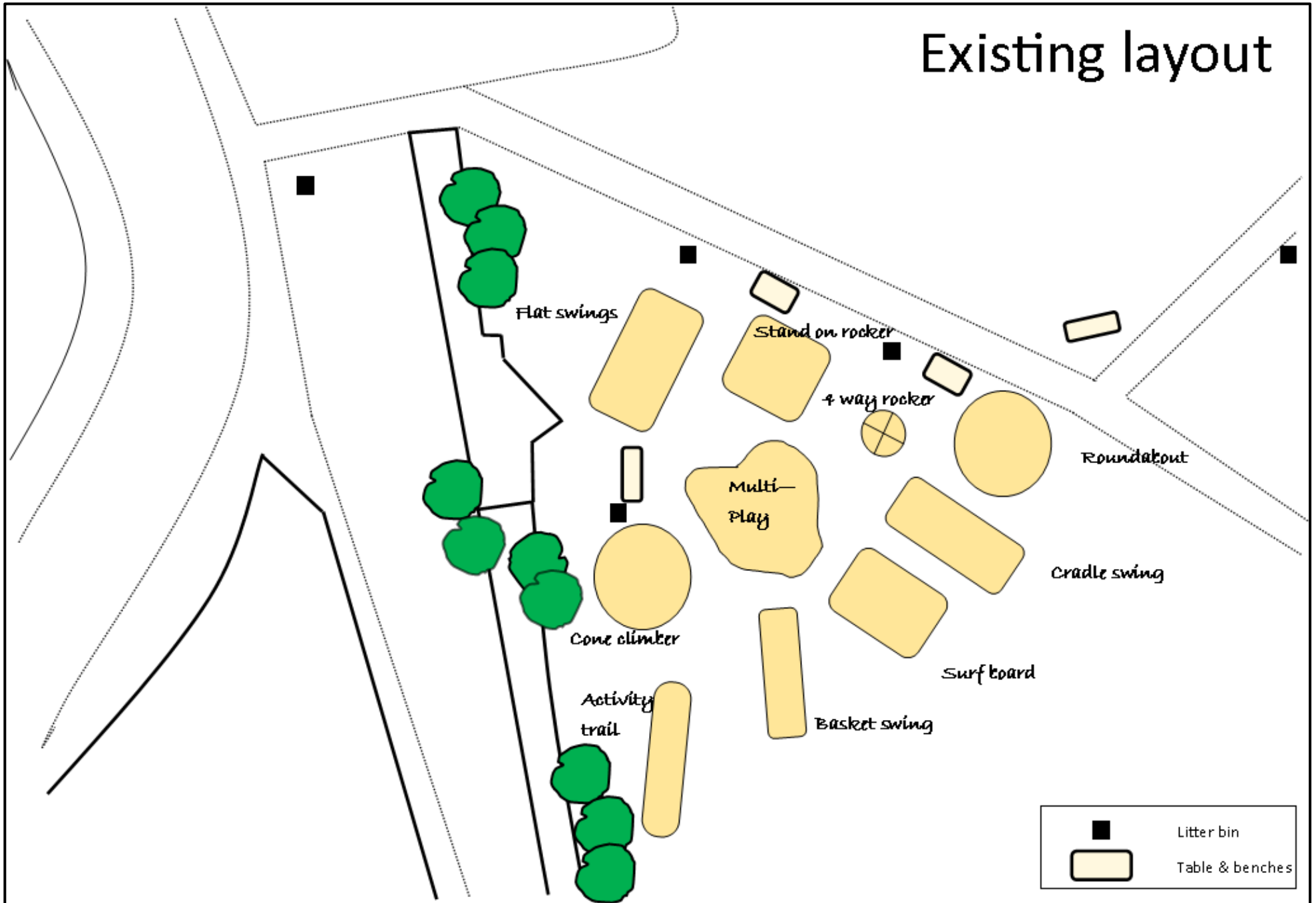

Proposed Layout

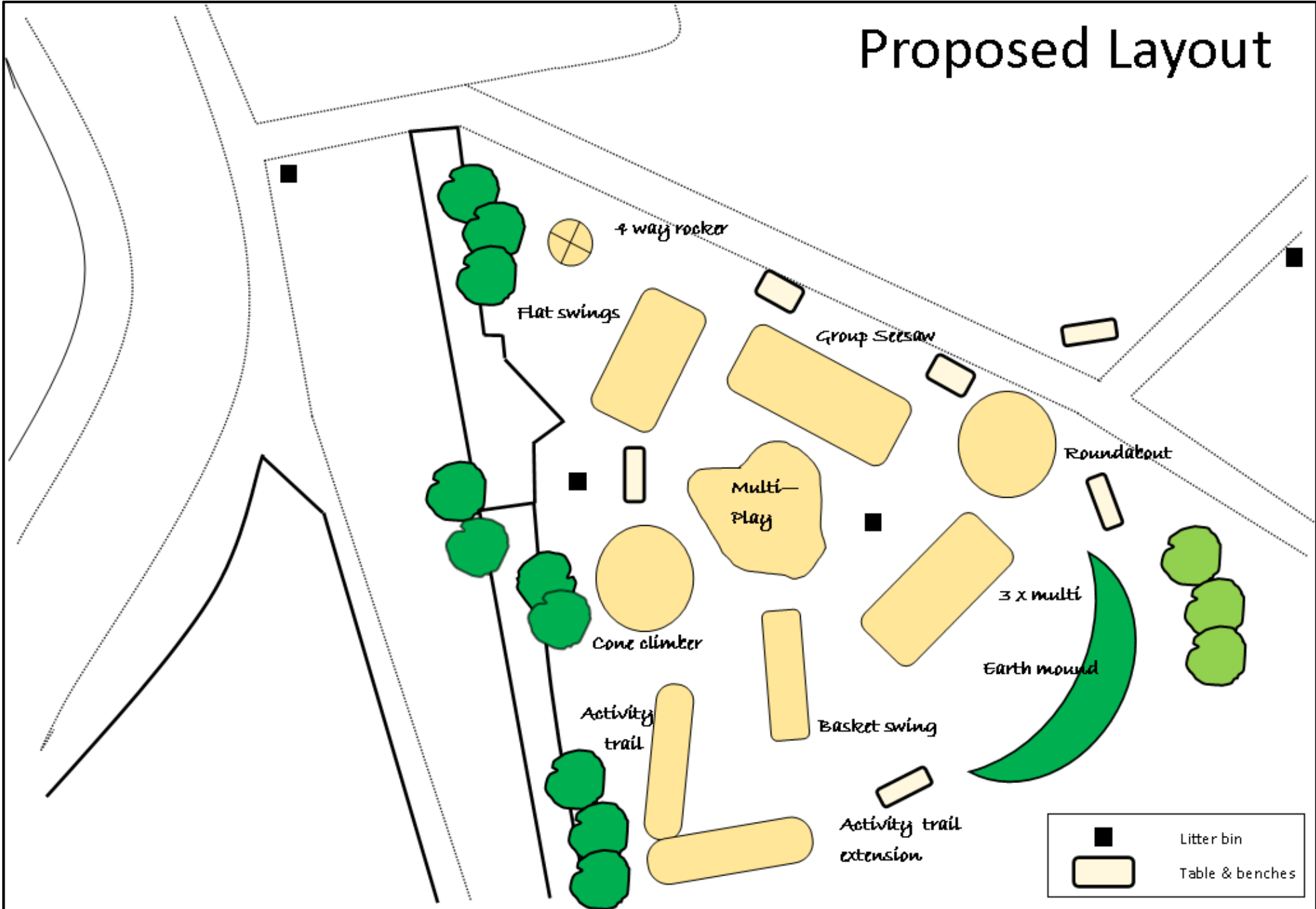

7 Playground Maintenance

7.1 It is proposed that the council's approach to maintenance of equipment on the playground will:

- Prioritise any high-risk items identified in the annual inspection report.
- Undertake running repairs were needed during the year.
- Undertake a thorough overhaul of one piece of equipment every year.

7.2 The 2024 annual inspection of the Greenside playground was completed in December. The report does not raise any high-risk issues requiring immediate action. The report does raise several low-risk issues.

| Equipment | Inspection Report | Proposed action in 2025/6 |
|--------------|---|--|
| Multi Play | A number of rope connector fixing(s) have worked loose | Secure all loose fixings |
| Flat Swing | The chain links are worn excessively and require renewing - replace worn chains The swing bar connecting lugs are showing signs of wear There is some wear to the shackles - monitor The bush / bushes is / are showing signs of wear The seat has minor damage or wear - monitor | Full overhaul |
| Signage | It is recommended that signage, with information including the site address, contact information for maintenance issues and emergency contact details are provided for the facility | Provide in accordance with the recommendations |
| Cone Climber | A number of fixing(s) have worked loose | Secure all loose fixings |
| Basket Swing | The seat is suspended unevenly | Adjust suspension so the seat is level at rest |
| Roundabout | No action required | |

| | | |
|-------------------|--|---------------------|
| Stand on Rocker | | Section 106 project |
| Cradle Swing | | Section 106 project |
| Four Way Springer | | Section 106 project |
| Surf Bord | | Section 106 project |
| Activity Trail | | Section 106 project |

7.3 Consideration also needs to be given to maintenance work to improve the general appearance of the site:

- Leaf litter and debris from the trees next to the playground to removed using a leaf blower – monthly
- Jet wash equipment and safety play surfaces – every two years.

8 Review of existing play equipment

Multi Play

Condition

- Some minor repairs

Annual Inspection report

- The play surface is lifting at the edges and creating trip points -Repair perimeter of surfacing to remove trip points
- There is moderate damage to the play surface – Repair
- A number of rope connector fixing(s) have worked loose. Secure all loose fixings

Comment

- Inspection report applying current standard to old piece of equipment
- Deterioration of the play surface will incur ongoing maintenance costs.

Proposal

- Include repairs in future program



Flat Swing

Condition

- Original piece of equipment
- Monitoring of chains and moving parts required.

Annual Inspection report

- The chain links are worn excessively and require renewing - replace worn chains
- The swing bar connecting lugs are showing signs of wear - monitor
- There is some wear to the shackles - monitor
- The bush / bushes is / are showing signs of wear – monitor
- The seat has minor damage or wear - monitor
- There are trip hazards at the edges of the surface – remove trip hazard

Comment

- Popular piece of equipment
- Deterioration in moving parts and chairs require regular monitoring
- Deterioration of bearings is causing nuisance noise affecting residents

Proposal

- Tender to include price for full overhaul.



Stand on Rocker

Condition

- The two bearing need to be replaced at a cost of £500.
- Tyre bumpers need replacing .
- Some damage to the safety play surface.

Annual Inspection report

- The damper tyres are damaged - Replace
- The paint is flaking off the metalwork - Rub down and repaint
- The pivot dampers are worn – Replace
- Replace all missing fixings on footrest

Comment

- Poor condition of the safety play surface has been repaired on at least two occasions and the surface over topped, which is why the surface stands 150mm about the original height.
- The stand on rocker needs to have over £500 spent on it to replace the worn bearings. In addition, the play surface and tyre bumpers are in a particularly poor condition.
- The replacement of this equipment with a new seesaw (details below) would be sensible as it would remove one of the older pieces of equipment, avoid the repair costs and deal with the deteriorating play surface at the same time.

Proposal

- Remove to make space for new equipment



Cradle Swing

Condition

- The Cradle Swing is the oldest piece of play equipment
- Previous work to paint the equipment has deteriorated
- Safety play surface tends to flood during heavy rain

Annual Inspection report

- There is some minor damage to the safety play surface - Monitor for any further deterioration and repair as required

Comment

- Equipment is very popular
- Play surface is 150mm lower than the surrounding land and the surface routinely floods during periods of heavy rain. The play surface is affected by algal growth.
- Poor play surface detracts from the appearance of the playground.
- Deterioration of the play surface will incur ongoing maintenance costs and ultimately will need to be replaced

Proposal

- replace two bay cradle swing with a three-bay swing with one seat being specifically designed to be all inclusive



Four Way Springer

Condition

- Good condition
- Spring replaced in 2022

Annual Inspection report

- The grass mats are silted up, the soil is compacted, and the area will become very slippery when the soil is wet. Reinststate as required

Comment

- The equipment is a popular piece of equipment.
- The lack of an all-weather play surface detracts from the appearance of the playground

Proposal

- Move to a different location next to the swings to enable new equipment to be installed.
- New location to include safety play surface.



Roundabout

Condition

- Good condition

Annual Inspection report

- There are trip hazards at the edges of the surface - Remove

Comment

- Popular piece of equipment
- Deterioration of the play surface will incur ongoing maintenance costs

Proposal

- No action



Surf Board

Condition

- Good condition

Annual Inspection report

- There are trip hazards at the edges of the surface - Remove
- trip hazard

Comment

- Least used piece of equipment
- Has limited value. Only been seen being used as a seat by children

Proposal

- Remove or relocate to provide space for three bay inclusive cradle swing



Basket Swing

Condition

- Good condition
- Chains and bushes replaced in 2024

Annual Inspection report

- The seat is suspended unevenly - Adjust suspension so the seat is level at rest
- There are trip hazards at the edges of the surface – Remove trip hazard

Comment

- There is some notable evidence of chain wear - Monitor for any further deterioration and replace when 40% worn
- The bushes are showing signs of wear – Monitor for any further deterioration and replace as required

Proposal

No action required – see note about trip hazard.



Cone Climber

Condition

- Good condition

Annual Inspection report

- A number of fixing(s) have worked loose - Secure all loose fixings
- There are trip hazards at the edges of the surface – Remove trip hazard

Comment

- This is a popular piece of equipment.
- Only routine maintenance work required.

Proposal

- No action required – see note about trip hazard.
- Undertake maintenance work.



Activity Trail

Condition

- Wooden construction is resulting in deterioration of the equipment.

Annual Inspection report

- The item has been damaged - Monitor for any further deterioration and replace as required
- The bearing is worn / damaged and the item is not operating correctly - Repair / replace
- The tree canopy overhangs the equipment and is less than 2.0m away - Lift tree canopy
- There is algae or moss on the surface of the equipment. Clean and treat appropriately
- There is some strimmer / machinery damage apparent on the posts,
- The surface has eroded in some areas and may be slippery in wet conditions - Reinstate the surface

Comment

- Inspection report identifies age related repairs

Proposal

- Routine maintenance to address over hanging branches.
- Add repairs to future repair program
- Tender to include options to extend activity trail



Litter Bins

Condition

- Open topped, metal liners not secured to frame, badly corroded.
- Location next to seating area not ideal

Annual Inspection report

- metal liners for round bins not secured to frame

Comment

- The three bins detract from the appearance of the playground and their design is no longer appropriate.
- Siting of the bins could be moved away from the seating and benches.

Proposal

- Replace with two new bins



Seating and benches

Condition

- 2 benches

Annual Inspection report

- The bitumen surface is worn or damaged - Repair the bitumen to provide a uniform surface
- There are trip hazards present - Remove trip hazard
- The paint is flaking off the metalwork - Rub down and repaint

Comment

- During busy periods more seating is needed to enhance the experience of parents and guardians.

Proposal

- Monitor condition of the benches and seats
- Consider replacing the old metal seat
- Add 1 or 2 new plastic benches on the southern edge of the playground



Signage

Condition

- Damaged

Annual Inspection report

- It is recommended that signage, with information including the site address, contact information for maintenance issues and emergency contact details are provided for the facility -Provide in accordance with the recommendations

Comment

- Sign damaged in 2024 and removed

Proposal

- Provide new sign with appropriate contact information



John Fraser
Parish Clerk
13 March 2025